

1A88F

King Slide®



Full Extension Concealed Slide with Cushion-closing and Push-open Feature for Faceframe Application

APPLICATIONS: Kitchen Furniture, Kitchen Cabinetry, Home Cabinetry and Box Drawers

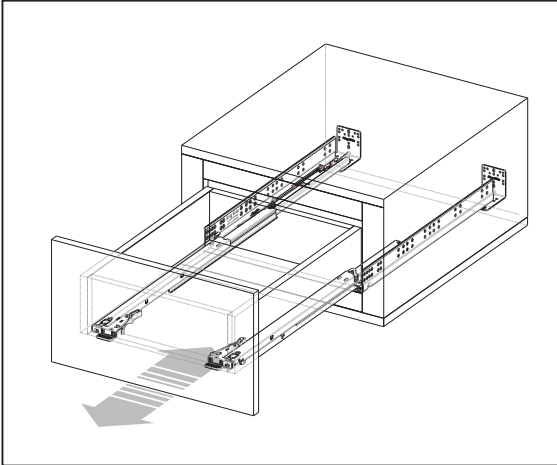

Specifications/Features

- Length : 12" / 15" / 18" / 21"
: 305 / 381 / 457 / 533 mm
- Drawer Side Thickness : 16mm (5/8") (max)
- Load Capacity : 34kg (75 lbs)/pair
- Travel : Full Extension
- Mount : Under Mount (for faceframe cabinet)
- Material : Galvanized Steel Sheet
- Features : Self-closing, Cushion-closing, Push-Open Feature, Tool-less Height Adjustment, Locking devices easy assembly
- Packing : Unit Packed : 6 pairs/carton
2 pairs/carton

SLIDES

Installation Specification

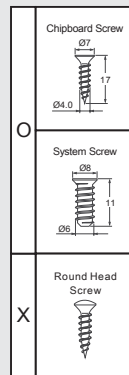
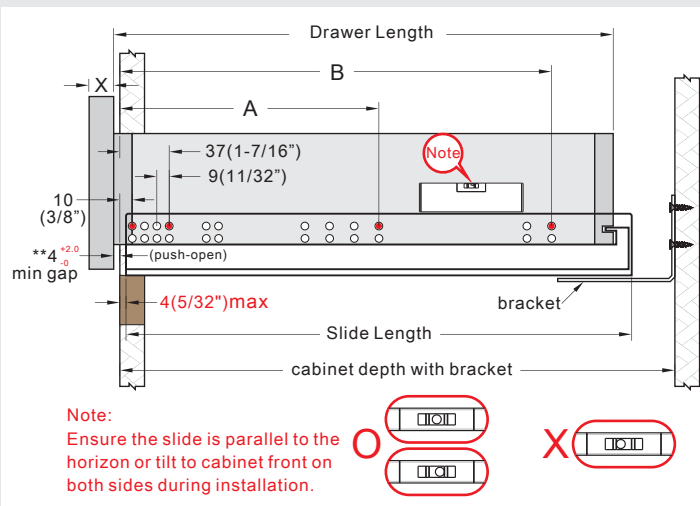

Rear Bracket

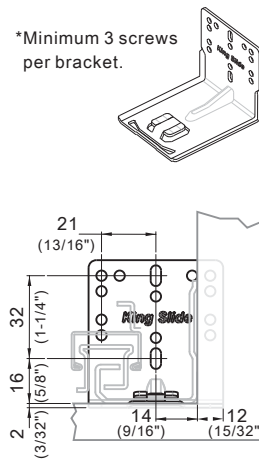

Part No.	Drawer Length	overall cabinet depth	cabinet depth with bracket		Profile Length	system screw locations	
			Max	Min		A	B
1A88F305	305 (12")	381 (15")	369 (14-9/16")	326 (12-7/8")	317 (12-1/2")	165 (6-1/2")	261 (10-1/4")
1A88F381	381 (15")	457 (18")	446 (17-9/16")	403 (15-7/8")	394 (15-1/2")	165 (6-1/2")	357 (14-1/16")
1A88F457	457 (18")	533 (21")	522 (20-9/16")	479 (18-7/8")	470 (18-1/2")	261 (10-1/4")	453 (17-13/16")
1A88F533	533 (21")	610 (24")	598 (23-9/16")	555 (21-7/8")	546 (21-1/2")	261 (10-1/4")	517 (20-3/8")

Fit with American standard 3" cabinet depth system.

Notes for Installation

1. Ensure the drawer body appearance is upright. It could not be diamond shaped, trapezoidal or distorted!
2. Ensure the side space, depth and horizon on both sides are consistent.
3. Ensure the installation location or the cabinet is on a flat surface.
4. Ensure the latch is installed correctly.
5. Ensure the drawer dimensions, rear notch locking hole, internal drawer width, and the drawer bottom recess are correct.

NOTE

King Slide reserves the right to alter specifications of all the products without notice. The actual product may vary from the illustration. If the entity is different from the illustration, please refer to the entity.

Space Requirement

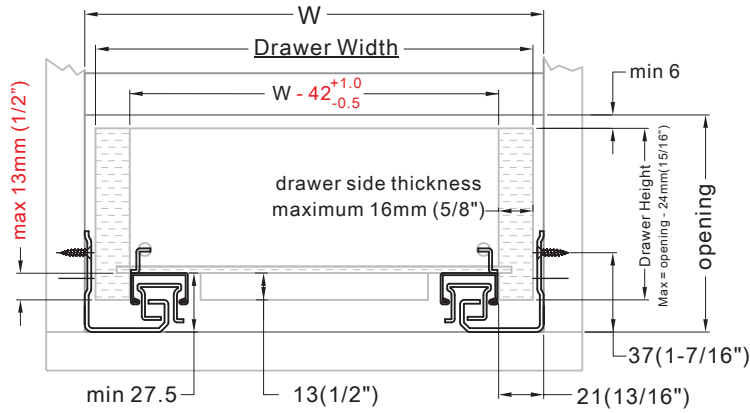

Drawer Width Formula	
drawer side thickness	"W" minus
16 (5/8")	10 (3/8")
15 (19/32")	12 (15/32")
14 (9/16")	14 (9/16")
13 (1/2")	16 (5/8")
12 (15/32")	18 (23/32")

W: Internal Cabinet Width

Example:

Internal Cabinet Width = 457 mm (18")

Drawer Side Thickness = 13 mm (1/2")

$$\text{Drawer width} = 457 - 16 = 441^{+1.0}_{-0.5} \text{ mm}$$

$$= (18") - (5/8") = 17\text{-}3/8"$$

Normal Install

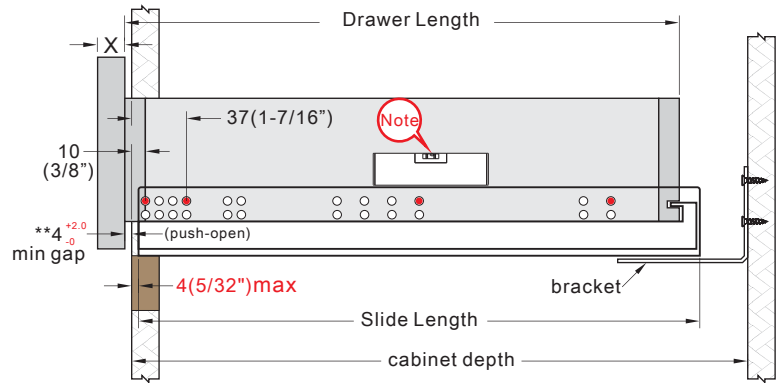

Inset Install

Inset install Formula							
X	16	17	18	19	20	21	22
Z	24	25	26	27	28	29	30
Y	57	58	59	60	61	62	63

L : Slide Length
X : Front Panel Thickness

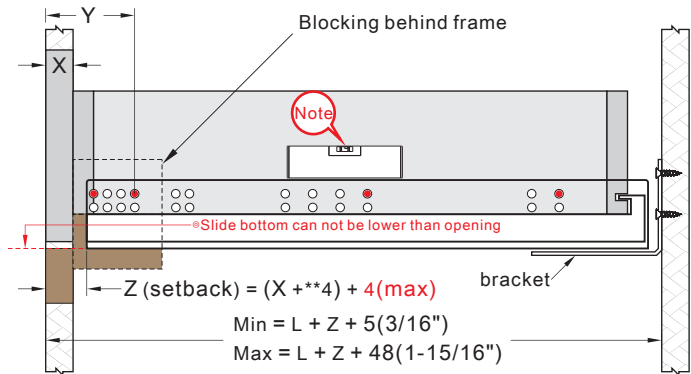

Note:
Ensure the slide is parallel to the horizon or tilt to cabinet front on both sides during installation.

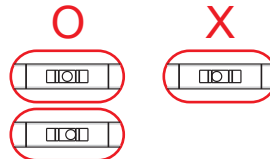

Drawer front height adjust

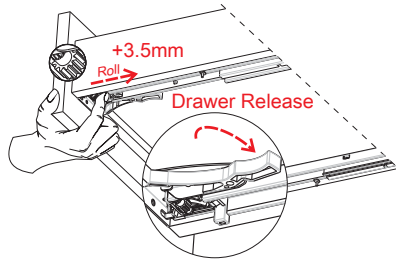

© In order to prevent an installation error, attach the drawer face as the final step.

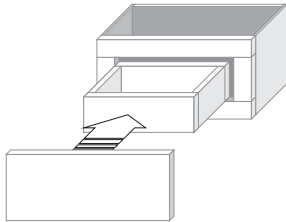

Installation Requirement

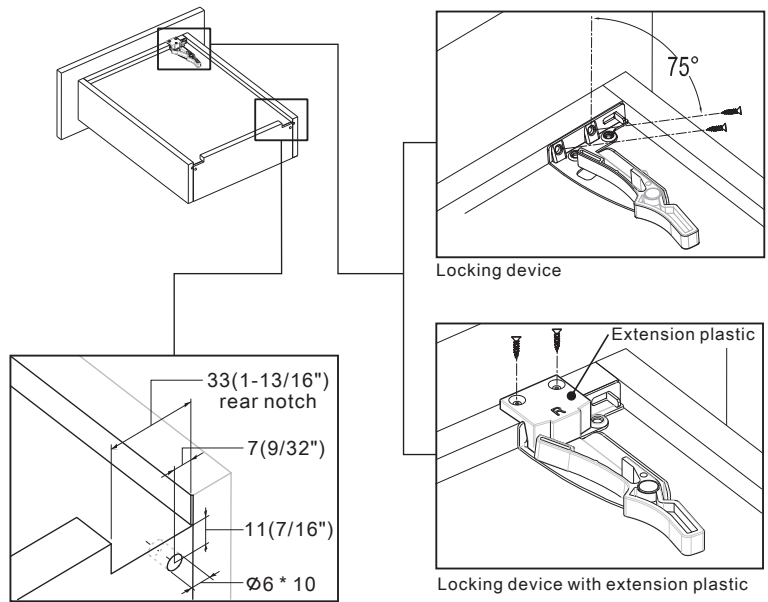

Detail Adjustment

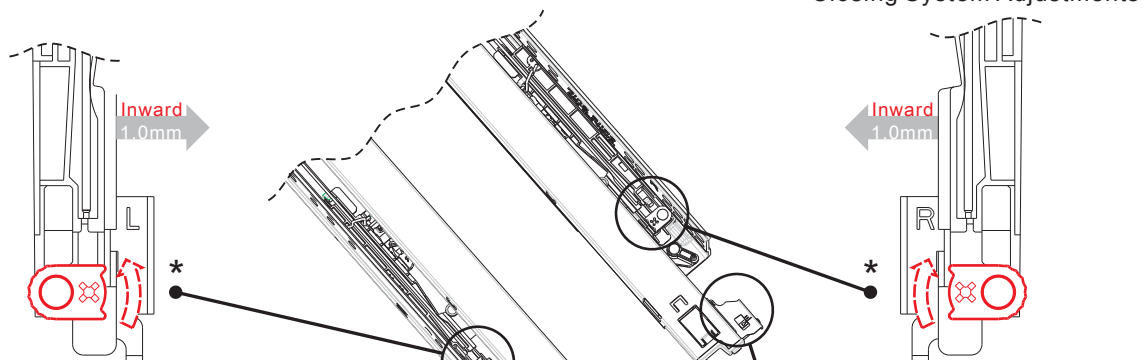

*Closing System Adjustments

* The adjustments here can fine-tune the slide function. If the issues still exist after the adjustments, please reset to default settings and ensure each installation dimension is in accordance with the specification.

Push-open Clearance Adjustment

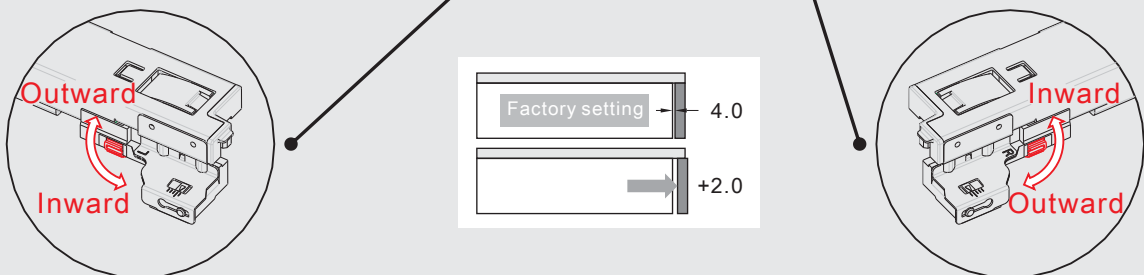

Comtrad - CANADA
Phone: 905-625-0564
email: sourcing@comtrad.ca

Comtrad - USA SOUTH
Phone: 954-415-7146
email: bpayanis@aol.com

GL Resources - USA NORTH
Phone: 616-456-9090
email: glr@glresources.net